

PROPERTY DESCRIPTION
24.117 Acres

Being a parcel of land situated in the Southwest Quarter of Section 6, Town 4 North, Range 3 East, Delaware Township, Defiance County, Ohio. Located within the North and East of the First Principal Meridian of the Original Land Subdivisions of Ohio, being more specifically described as follows:

Commencing at the Northwest Corner of the Southwest Quarter of said Section 6, said point being an iron pin found this survey and the TRUE POINT OF BEGINNING of the parcel herein described;

Thence, South 87 degrees 51 minutes 43 seconds East along the North line of the Southwest Quarter of said Section 6 a distance of 30.00 feet to an iron pin placed this survey;

Thence, continuing South 87 degrees 51 minutes 43 seconds East along the North line of the Southwest Quarter of said Section 6 a distance of 1300.04 feet to an iron pin found this survey;

Thence, South 0 degrees 57 minutes 00 seconds West a distance of 685.00 feet to an iron pin placed this survey;

Thence, North 87 degrees 51 minutes 43 seconds West a distance of 358.00 feet to an iron pin placed this survey;

Thence, continuing North 87 degrees 51 minutes 43 seconds West a distance of 50.00 feet to a point established this survey;

Thence, South 2 degrees 12 minutes 57 seconds West along the approximate centerline of a drainage ditch a distance of 115.61 feet to a point established this survey;

Thence, South 33 degrees 19 minutes 29 seconds West along the approximate centerline of a drainage ditch a distance of 25.00 feet to a point established this survey;

Thence, South 67 degrees 06 minutes 19 seconds West along the approximate centerline of a drainage ditch a distance of 25.00 feet to a point established this survey;

Thence, North 86 degrees 28 minutes 36 seconds West along the approximate centerline of a drainage ditch a distance of 175.00 feet to a point established this survey;

Thence, North 88 degrees 37 minutes 45 seconds West along the approximate centerline of a drainage ditch a distance of 200.00 feet to a point established this survey;

Thence, North 88 degrees 41 minutes 37 seconds West along the approximate centerline of a drainage ditch a distance of 200.00 feet to a point established this survey;

Thence, North 86 degrees 59 minutes 26 seconds West along the approximate centerline of a drainage ditch a distance of 200.00 feet to a point established this survey;

Thence, South 56 degrees 15 minutes 32 seconds West along the approximate centerline of a drainage ditch a distance of 135.00 feet to a MAG Nail placed this survey;

Thence, North 1 degree 07 minutes 01 seconds East along the West line of the Southwest Quarter of said Section 6 a distance of 910.00 feet to the TRUE POINT OF BEGINNING of the parcel herein described, containing 24.117 acres of land, more or less, and subject to highways rights-of-way and easements of record as surveyed by Brian M. Wieland, Registered Surveyor Number 8286 on August 17th, 2019 and recorded in the Defiance County Survey Records.

Bearings and distances are based on State Plane Coordinates, SPC83, Zone-Ohio North. Monuments described above as "Iron Pin Placed" are 5/8-inch diameter by 30-inch rebar with yellow plastic cap stamped "Wieland-8286."

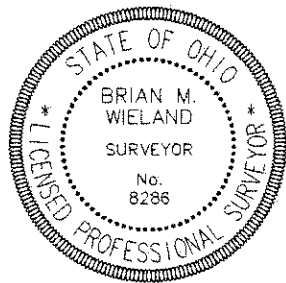

Brian M. Wieland
Brian M. Wieland
Registered Surveyor No. 8286

07-06-09A ①

PROPERTY DESCRIPTION
57.245 Acres

Being a parcel of land situated in the Southwest Quarter of Section 6, Town 4 North, Range 3 East, Delaware Township, Defiance County, Ohio. Located within the North and East of the First Principal Meridian of the Original Land Subdivisions of Ohio, being more specifically described as follows:

Commencing at the Southwest Corner of said Section 6, said point being an iron pin found this survey and the TRUE POINT OF BEGINNING of the parcel herein described;

Thence, North 1 degree 07 minutes 01 seconds East along the West line of the Southwest Quarter of said Section 6 a distance of 1748.12 feet to a MAG Nail placed this survey;

Thence, North 56 degrees 15 minutes 32 seconds East along the approximate centerline of a drainage ditch a distance of 135.00 feet to a point established this survey;

Thence, South 86 degrees 59 minutes 26 seconds East along the approximate centerline of a drainage ditch a distance of 200.00 feet to a point established this survey;

Thence, South 88 degrees 41 minutes 37 seconds East along the approximate centerline of a drainage ditch a distance of 200.00 feet to a point established this survey;

Thence, South 88 degrees 37 minutes 45 seconds East along the approximate centerline of a drainage ditch a distance of 200.00 feet to a point established this survey;

Thence, South 86 degrees 28 minutes 36 seconds East along the approximate centerline of a drainage ditch a distance of 175.00 feet to a point established this survey;

Thence, North 67 degrees 06 minutes 19 seconds East along the approximate centerline of a drainage ditch a distance of 25.00 feet to a point established this survey;

Thence, North 33 degrees 19 minutes 29 seconds East along the approximate centerline of a drainage ditch a distance of 25.00 feet to a point established this survey;

Thence, North 2 degrees 12 minutes 57 seconds East along the approximate centerline of a drainage ditch a distance of 115.61 feet to a point established this survey;

Thence, South 87 degrees 51 minutes 43 seconds East a distance of 50.00 feet to an iron pin placed this survey;

Thence, continuing South 87 degrees 51 minutes 43 seconds East a distance of 358.00 feet to an iron pin placed this survey;

Thence, South 0 degrees 57 minutes 00 seconds West a distance of 1946.76 feet to an iron pin found this survey;

Thence, continuing South 0 degrees 57 minutes 00 seconds West a distance of 25.00 feet to a railroad spike found this survey;

Thence, North 87 degrees 55 minutes 36 seconds West along the South line of the Southwest Quarter of said Section 6 a measured distance of 1337.76 feet to the TRUE POINT OF BEGINNING of the parcel herein described, containing 57.245 acres of land, more or less, and subject to highways rights-of-way and easements of record as surveyed by Brian M. Wieland, Registered Surveyor Number 8286 on August 17th, 2019 and recorded in the Defiance County Survey Records.

Bearings and distances are based on State Plane Coordinates, SPC83, Zone-Ohio North. Monuments described above as "Iron Pin Placed" are 5/8-inch diameter by 30-inch rebar with yellow plastic cap stamped "Wieland-8286."



Brian M. Wieland
Brian M. Wieland
Registered Surveyor No. 8286