

**Point Number:** 44351

**Observation:** GES

**Date:** 5-25-04

**Township:** Defiance

**Section:** 35

**Monument Description:** Rod in concrete cylinder

**Monument Location:** In island where Palmer Dr. meets Route 66. In a concrete cylinder below ground covered with a aluminum lid. Lies 40' W of centerline of old Palmer Dr. and 108.9' NW of a fire hydrant.

**Sketch:**

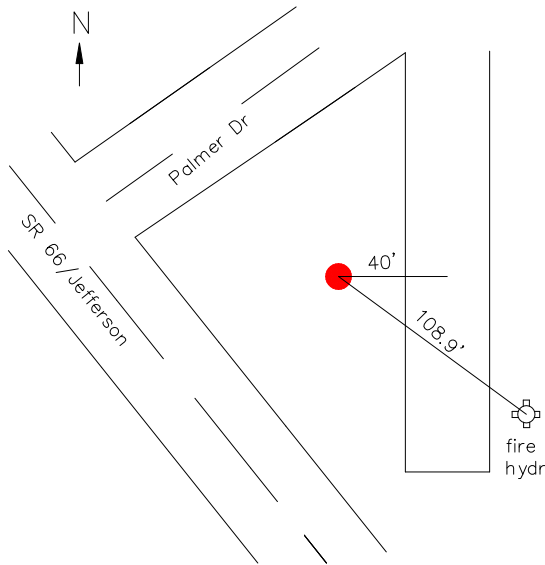

**Photo:**



**Sky Observation Chart:**

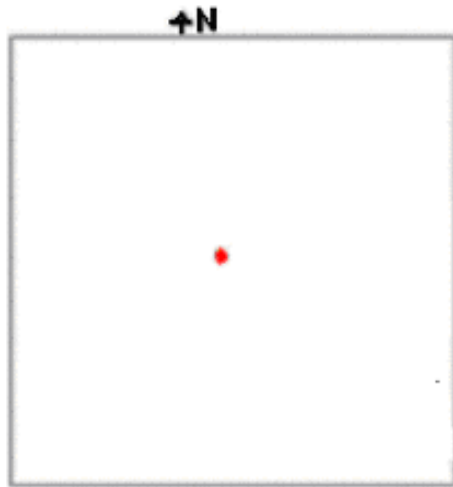

Trees should not pose a problem

Defiance County GPS Coordinates

Northing—586368.221 sft

Easting—1456840.369 sft

Elevation—711.98 ft

NGS Coordinates &

ODOT Coordinates (DEF 66)

Northing—586368.221 sft

Easting—1456840.370 sft

Elevation—711.98 ft

Grade Quality: A