

Point Number: 53021 Observation: GES Date: 6-15-04

Township: Washington Section: 02

Monument Description: Disc in NW type A G-rail turndown

Monument Location: On Flickinger Rd. north of Scott Rd. 1<sup>st</sup> bridge N of Scott Rd.  
17.5øW of Flickinger Rd CL

Sketch:

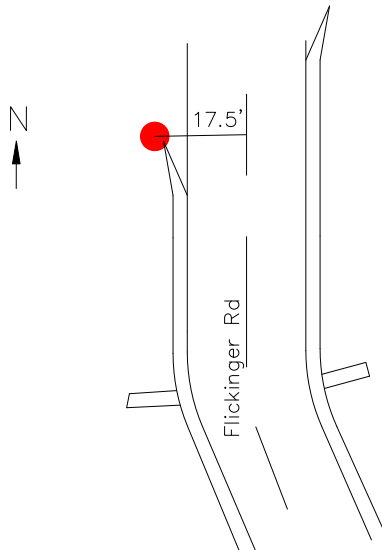
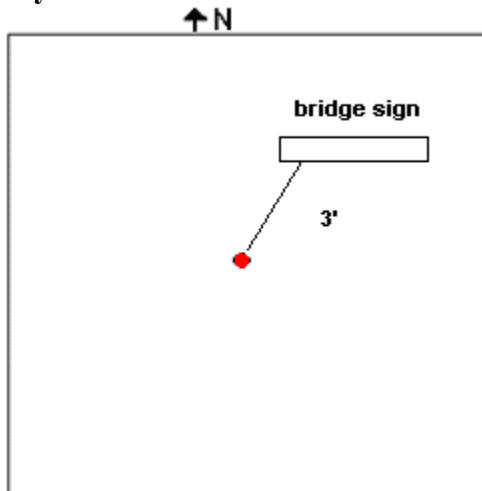

Photo:



Sky Observation Chart



Defiance County GPS Coordinates

Northing—643676.372 sft

Easting—1425777.029 sft

Elevation—705.96 ft

Clear Skies.