

Ashwood Rd  
Vacation Plot  
Sections 25 and 36 of Delaware Township  
Sections 30 and 31 of Defiance Township

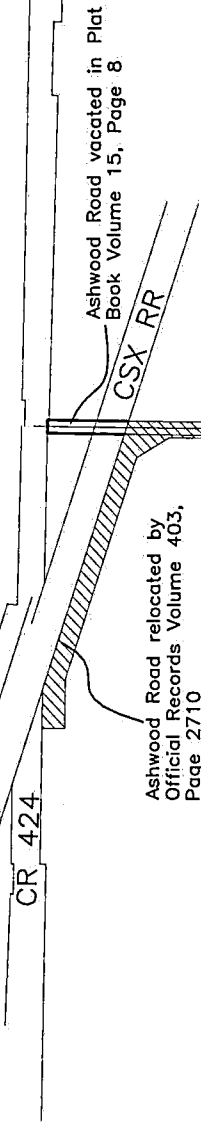

Ashwood Road established in Road Book 1, Page 298

This plat shows the vacation of Ashwood Rd. beginning at the south right of way line of CR424 and extending south to the East quarter corner of Section 36 in Delaware Township.

0 200'

This vacation was approved by the Defiance County Commissioners by a resolution dated 04/29/2026 and is recorded in Volume 174, Resolution 2604206 of the Defiance County Commissioners Journal.

South Line of Section 25, Delaware Twp  
North Line of Section 36, Delaware Twp

South Line of Section 30, Defiance Twp  
North Line of Section 31, Defiance Twp

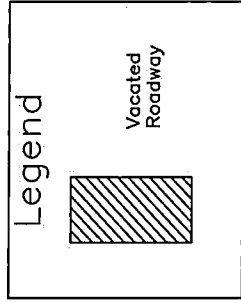

E-W Quarterline of Section 36, Delaware TWP

E-W Quarterline of Section 31, Defiance TWP

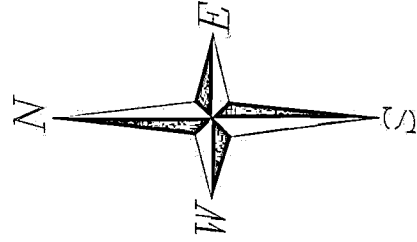

Plat prepared by the Defiance County Engineer's Office

*Warren Schlatter*  
Warren Schlatter P.E., P.S., County Engineer

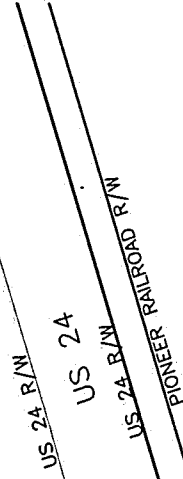

Ashwood Rd vacated in Plat Book Volume 14, Page 245

Def/Paut Co Line Powers Rd

DEFIANCE COUNTY AUDITOR CERTIFICATION  
I, the Defiance County Auditor, do hereby acknowledge receipt of the plat.

*Jill Little*      *4-29-26*  
Jill Little, Defiance County Auditor      Date

#1463

Files and Recorded the 30<sup>th</sup> day of April 2026, at Plat Book Volume 15, Page 51

*Cecilia D. Parsons*  
Cecilia Parsons, Defiance County Recorder \$0.00