

PROPERTY DESCRIPTION
6.396 Acres

Being a parcel of land situated in the Northwest Quarter of Section 7, Town 5 North, Range 2 East, Farmer Township, Defiance County, Ohio. Located within the North and East of the First Principal Meridian of the Original Land Subdivisions of Ohio, being more specifically described as follows:

Commencing at the Northwest Corner of said Section 7, said point being an Iron Pin found this survey and the TRUE POINT OF BEGINNING of the parcel herein described;

Thence, South 89 degrees 24 minutes 28 seconds East along the North line of the Northwest Quarter of said Section 7 a distance of 915.24 feet to a point established this survey;

Thence, South 14 degrees 57 minutes 28 seconds East a distance of 20.00 feet to an iron pin found this survey;

Thence, continuing South 14 degrees 57 minutes 28 seconds East a distance of 543.11 feet to an iron pin found this survey;

Thence, North 89 degrees 24 minutes 28 seconds West a distance of 208.48 feet to an iron pin found this survey;

Thence, North 21 degrees 35 minutes 44 seconds West a distance of 62.00 feet to a point established this survey;

Thence, North 35 degrees 19 minutes 17 seconds West along the approximate centerline of a drainage ditch a distance of 100.00 feet to a point established this survey;

Thence, North 65 degrees 56 minutes 13 seconds West along the approximate centerline of a drainage ditch a distance of 75.00 feet to a point established this survey;

Thence, North 78 degrees 08 minutes 06 seconds West along the approximate centerline of a drainage ditch a distance of 60.00 feet to a point established this survey;

Thence, North 65 degrees 00 minutes 26 seconds West along the approximate centerline of a drainage ditch a distance of 35.00 feet to a point established this survey;

Thence, North 52 degrees 59 minutes 14 seconds West along the approximate centerline of a drainage ditch a distance of 85.00 feet to a point established this survey;

Thence, North 58 degrees 52 minutes 52 seconds West along the approximate centerline of a drainage ditch a distance of 50.00 feet to a point established this survey;

Thence, North 51 degrees 59 minutes 24 seconds West along the approximate centerline of a drainage ditch a distance of 75.00 feet to a point established this survey;

Thence, North 58 degrees 27 minutes 53 seconds West along the approximate centerline of a drainage ditch a distance of 150.00 feet to a point established this survey;

Thence, North 77 degrees 55 minutes 47 seconds West along the approximate centerline of a drainage ditch a distance of 50.00 feet to a point established this survey;

Thence, North 69 degrees 37 minutes 19 seconds West along the approximate centerline of a drainage ditch a distance of 100.00 feet to a point established this survey;

Thence, North 82 degrees 37 minutes 13 seconds West along the approximate centerline of a drainage ditch a distance of 175.00 feet to a MAG Nail placed this survey;

Thence, North 0 degrees 52 minutes 32 seconds East along the West line of the Northwest Quarter of said Section 7 a measured distance of 85.00 feet to the TRUE POINT OF BEGINNING of the parcel herein described, containing 6.396 acres of land, more or less, and subject to highways rights-of-way and easements of record as surveyed by Brian M. Wieland, Registered Surveyor Number 8286 on November 13th, 2021 and recorded in the Defiance County Survey Records.

Bearings and distances are based on State Plane Coordinates, SPC83, Zone-Ohio North. Monuments described above as "Iron Pins Set" are 5/8-inch diameter by 30-inch rebar with yellow plastic cap stamped "Wieland-8286."

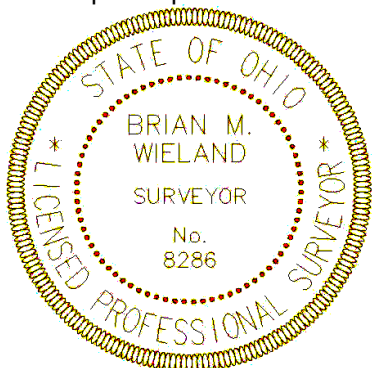

Brian M. Wieland
Registered Surveyor No. 8286

PROPERTY DESCRIPTION
12.330 Acres

Being a parcel of land situated in the Northwest Quarter of Section 7, Town 5 North, Range 2 East, Farmer Township, Defiance County, Ohio. Located within the North and East of the First Principal Meridian of the Original Land Subdivisions of Ohio, being more specifically described as follows:

Commencing at the Northwest Corner of said Section 7, said point being an Iron Pin found this survey;

Thence, South 0 degrees 52 minutes 32 seconds East along the West line of the Northwest Quarter of said Section 7 a distance of 85.00 feet to a MAG Nail placed this survey and the TRUE POINT OF BEGINNING of the parcel herein described;

Thence, South 82 degrees 37 minutes 13 seconds East along the approximate centerline of a drainage ditch a distance of 175.00 feet to a point established this survey;

Thence, South 69 degrees 37 minutes 19 seconds East along the approximate centerline of a drainage ditch a distance of 100.00 feet to a point established this survey;

Thence, South 77 degrees 55 minutes 47 seconds East along the approximate centerline of a drainage ditch a distance of 50.00 feet to a point established this survey;

Thence, South 58 degrees 27 minutes 53 seconds East along the approximate centerline of a drainage ditch a distance of 150.00 feet to a point established this survey;

Thence, South 51 degrees 59 minutes 24 seconds East along the approximate centerline of a drainage ditch a distance of 75.00 feet to a point established this survey;

Thence, South 58 degrees 52 minutes 52 seconds East along the approximate centerline of a drainage ditch a distance of 50.00 feet to a point established this survey;

Thence, South 52 degrees 59 minutes 14 seconds East along the approximate centerline of a drainage ditch a distance of 85.00 feet to a point established this survey;

Thence, South 65 degrees 00 minutes 26 seconds East along the approximate centerline of a drainage ditch a distance of 35.00 feet to a point established this survey;

Thence, South 78 degrees 08 minutes 06 seconds East along the approximate centerline of a drainage ditch a distance of 60.00 feet to a point established this survey;

Thence, South 65 degrees 56 minutes 13 seconds East along the approximate centerline of a drainage ditch a distance of 75.00 feet to a point established this survey;

Thence, South 35 degrees 19 minutes 17 seconds East along the approximate centerline of a drainage ditch a distance of 100.00 feet to a point established this survey;

Thence, South 21 degrees 35 minutes 44 seconds East a distance of 62.00 feet to an iron pin found this survey;

Thence, South 0 degrees 52 minutes 32 seconds West a distance of 375.00 feet to an iron pin placed this survey;

Thence, continuing South 0 degrees 52 minutes 32 seconds West a distance of 186.00 feet to a point established this survey;

Thence, North 50 degrees 37 minutes 40 seconds West along the approximate centerline of a drainage ditch a distance of 17.00 feet to a point established this survey;

Thence, North 9 degrees 42 minutes 56 seconds East along the approximate centerline of a drainage ditch a distance of 22.00 feet to a point established this survey;

Thence, North 22 degrees 33 minutes 49 seconds West along the approximate centerline of a drainage ditch a distance of 30.00 feet to a point established this survey;

Thence, South 74 degrees 29 minutes 21 seconds West along the approximate centerline of a drainage ditch a distance of 15.00 feet to a point established this survey;

Thence, South 88 degrees 54 minutes 11 seconds West along the approximate centerline of a drainage ditch a distance of 25.00 feet to a point established this survey;

Thence, North 54 degrees 53 minutes 59 seconds West along the approximate centerline of a drainage ditch a distance of 35.00 feet to a point established this survey;

Thence, South 87 degrees 43 minutes 17 seconds West along the approximate centerline of a drainage ditch a distance of 50.00 feet to a point established this survey;

Thence, South 68 degrees 36 minutes 28 seconds West along the approximate centerline of a drainage ditch a distance of 30.00 feet to a point established this survey;

Thence, South 86 degrees 11 minutes 27 seconds West along the approximate centerline of a drainage ditch a distance of 30.00 feet to a point established this survey;

Thence, North 45 degrees 14 minutes 58 seconds West along the approximate centerline of a drainage ditch a distance of 30.00 feet to a point established this survey;

Thence, North 16 degrees 58 minutes 25 seconds East along the approximate centerline of a drainage ditch a distance of 40.00 feet to a point established this survey;

Thence, North 2 degrees 54 minutes 11 seconds West along the approximate centerline of a drainage ditch a distance of 50.00 feet to a point established this survey;

Thence, North 78 degrees 43 minutes 26 seconds West along the approximate centerline of a drainage ditch a distance of 35.00 feet to a point established this survey;

Thence, North 33 degrees 51 minutes 34 seconds West along the approximate centerline of a drainage ditch a distance of 35.00 feet to a point established this survey;

Thence, North 13 degrees 35 minutes 01 seconds East along the approximate centerline of a drainage ditch a distance of 75.00 feet to a point established this survey;

Thence, North 66 degrees 54 minutes 58 seconds West along the approximate centerline of a drainage ditch a distance of 50.00 feet to a point established this survey;

Thence, North 87 degrees 04 minutes 59 seconds West along the approximate centerline of a drainage ditch a distance of 565.00 feet to a MAG Nail placed this survey;

Thence, North 0 degrees 52 minutes 32 seconds East along the West line of the Northwest Quarter of said Section 7 a measured distance of 700.00 feet to the TRUE POINT OF BEGINNING of the parcel herein described, containing 12.330 acres of land, more or less, and subject to highways rights-of-way and easements of record as surveyed by Brian M. Wieland, Registered Surveyor Number 8286 on November 13th, 2021 and recorded in the Defiance County Survey Records.

Bearings and distances are based on State Plane Coordinates, SPC83, Zone-Ohio North. Monuments described above as "Iron Pins Set" are 5/8-inch diameter by 30-inch rebar with yellow plastic cap stamped "Wieland-8286."



Brian M. Wieland
Registered Surveyor No. 8286

