

**PROPERTY DESCRIPTION**  
**3.812 Acres**

Being a parcel of land situated in the Northwest Quarter of Section 24, Town 5 North, Range 3 East, Farmer Township, Defiance County, Ohio. Located within the North and East of the First Principal Meridian of the Original Land Subdivisions of Ohio, being more specifically described as follows:

Commencing at the Northwest Corner of said Section 24, said point being a Railroad Spike found this survey and the TRUE POINT OF BEGINNING of the parcel herein described;

Thence, South 89 degrees 07 minutes 45 seconds East along the North line of the Northwest Quarter of said Section 24 a previous survey distance of 664.23 feet to a point established this survey;

Thence, South 0 degrees 44 minutes 12 seconds West a distance of 40.00 feet to an iron pin found this survey;

Thence, continuing South 0 degrees 44 minutes 12 seconds West a distance of 210.00 feet to an iron pin placed this survey;

Thence, North 89 degrees 07 minutes 45 seconds West a distance of 634.21 feet to an iron pin placed this survey;

Thence, continuing North 89 degrees 07 minutes 45 seconds West a distance of 30.00 feet to a point established this survey;

Thence, North 0 degrees 43 minutes 58 seconds East along the West line of the Northwest Quarter of said Section 24 a distance of 250.00 feet to the TRUE POINT OF BEGINNING of the parcel herein described, containing 3.812 acres of land, more or less, and subject to highways rights-of-way and easements of record as surveyed by Brian M. Wieland, Registered Surveyor Number 8286 on October 20<sup>th</sup>, 2020 and recorded in the Defiance County Survey Records.

Bearings and distances are based on State Plane Coordinates, SPC83, Zone-Ohio North. Monuments described above as "Iron Pin Placed" are 5/8-inch diameter by 30-inch rebar with yellow plastic cap stamped "Wieland-8286."

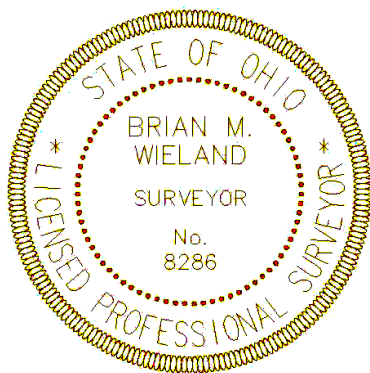

Brian M. Wieland  
Registered Surveyor No. 8286