

PROPERTY DESCRIPTION
1.686 Acres
North Part of Parcel

Being a parcel of land situated in the Southwest Quarter of Section 35, Town 5 North, Range 2 East, Farmer Township, Defiance County, Ohio. Located within the North and the East of the First Principal Meridian of the Original Land Subdivisions of Ohio, being more specifically described as follows:

Commencing at the Southwest Corner of said Section 35, said point being a Railroad Spike found this survey;

Thence, North 0 degrees 36 minutes 57 seconds East along the West line of the Southwest Quarter of said Section 35 a distance of 1079.44 feet to a point established this survey and the TRUE POINT OF BEGINNING of the parcel herein described;

Thence, continuing North 0 degrees 36 minutes 57 seconds East along the West line of the Southwest Quarter of said Section 35 a distance of 240.00 feet to a railroad spike found this survey;

Thence, South 88 degrees 48 minutes 27 seconds East a distance of 20.00 feet to an iron pin found this survey;

Thence, continuing South 88 degrees 48 minutes 27 seconds East a distance of 286.00 feet to an iron pin found this survey;

Thence, South 0 degrees 36 minutes 57 seconds West a distance of 240.00 feet to an iron pin placed this survey;

Thence, North 88 degrees 48 minutes 27 seconds West a distance of 281.00 feet to an iron pin placed this survey;

Thence, continuing North 88 degrees 48 minutes 27 seconds West a distance of 25.00 feet to the TRUE POINT OF BEGINNING of the parcel herein described, containing 1.686 acres of land, more or less, and subject to highways rights-of-way and easements of record as surveyed by Brian M. Wieland, Registered Surveyor Number 8286 on May 29th, 2021 and recorded in the Defiance County Survey Records.

Bearings and distances are based on State Plane Coordinates, SPC83, Zone-Ohio North. Monuments described above as "Iron Pin Placed" are 5/8-inch diameter by 30-inch rebar with yellow plastic cap stamped "Wieland-8286."

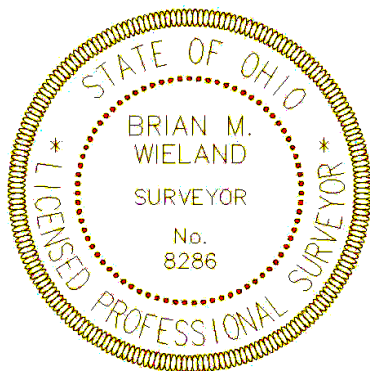

Brian M. Wieland
Registered Surveyor No. 8286

PROPERTY DESCRIPTION
2.388 Acres
South Part of Parcel

Being a parcel of land situated in the Southwest Quarter of Section 35, Town 5 North, Range 2 East, Farmer Township, Defiance County, Ohio. Located within the North and the East of the First Principal Meridian of the Original Land Subdivisions of Ohio, being more specifically described as follows:

Commencing at the Southwest Corner of said Section 35, said point being a Railroad Spike found this survey;

Thence, North 0 degrees 36 minutes 57 seconds East along the West line of the Southwest Quarter of said Section 35 a distance of 7399.44 feet to railroad spike found this survey and the TRUE POINT OF BEGINNING of the parcel herein described;

Thence, continuing North 0 degrees 36 minutes 57 seconds East along the West line of the Southwest Quarter of said Section 35 a distance of 340.00 feet to a point established this survey;

Thence, South 88 degrees 48 minutes 27 seconds East a distance of 25.00 feet to an iron pin placed this survey;

Thence, continuing South 88 degrees 48 minutes 27 seconds East a distance of 281.00 feet to an iron pin placed this survey;

Thence, South 0 degrees 36 minutes 57 seconds West a distance of 340.00 feet to an iron pin found this survey;

Thence, North 88 degrees 48 minutes 27 seconds West a distance of 286.00 feet to an iron pin found this survey;

Thence, continuing North 88 degrees 48 minutes 27 seconds West a distance of 20.00 feet to the TRUE POINT OF BEGINNING of the parcel herein described, containing 2.388 acres of land, more or less, and subject to highways rights-of-way and easements of record as surveyed by Brian M. Wieland, Registered Surveyor Number 8286 on May 29th, 2021 and recorded in the Defiance County Survey Records.

Bearings and distances are based on State Plane Coordinates, SPC83, Zone-Ohio North. Monuments described above as "Iron Pin Placed" are 5/8-inch diameter by 30-inch rebar with yellow plastic cap stamped "Wieland-8286."



Brian M. Wieland
Registered Surveyor No. 8286