

**A SURVEY BEING PART OF THE SOUTHWEST QUARTER OF SECTION 18,  
AND PART OF THE NORTHWEST QUARTER OF SECTION 19,  
T. 4-N., R. 1-E., HICKSVILLE TOWNSHIP,  
DEFIANCE COUNTY, OHIO**

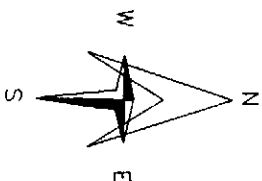
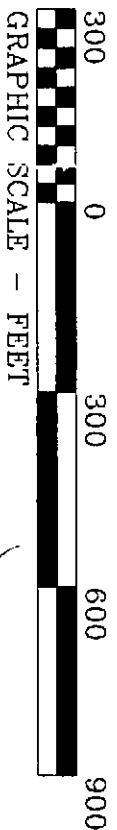

- REFERENCE SURVEYS**
- Vol. 12, Pg. 18-1
  - Vol. 12, Pg. 18-2
  - Vol. 12, Pg. 18-3
  - Vol. 12, Pg. 18-4
  - Vol. 12, Pg. 18-5
  - Vol. 12, Pg. 18-6
  - Vol. 12, Pg. 18-7
  - Vol. 12, Pg. 18-8
  - Vol. 12, Pg. 19-1
  - Vol. 12, Pg. 19-2
  - Vol. 12, Pg. 19-6

**DEED REFERENCE**  
Vol. 262, Pg. 863

- A = 5/8" iron pin fd. on the W. line, Sec. 19
- B = 1" Open pipe fd. @ N.W. cor., N.W. 1/4, Sec. 19
- C = 5/8" iron pin fd. on the W. line, Sec. 18
- D = Monument stone fd.
- E = Railroad spike fd.
- F = 5/8" iron pin fd. on C/L Spencerville-Hicksville
- G = Point established
- H = 5/8" X 30" iron pin & reference cap set

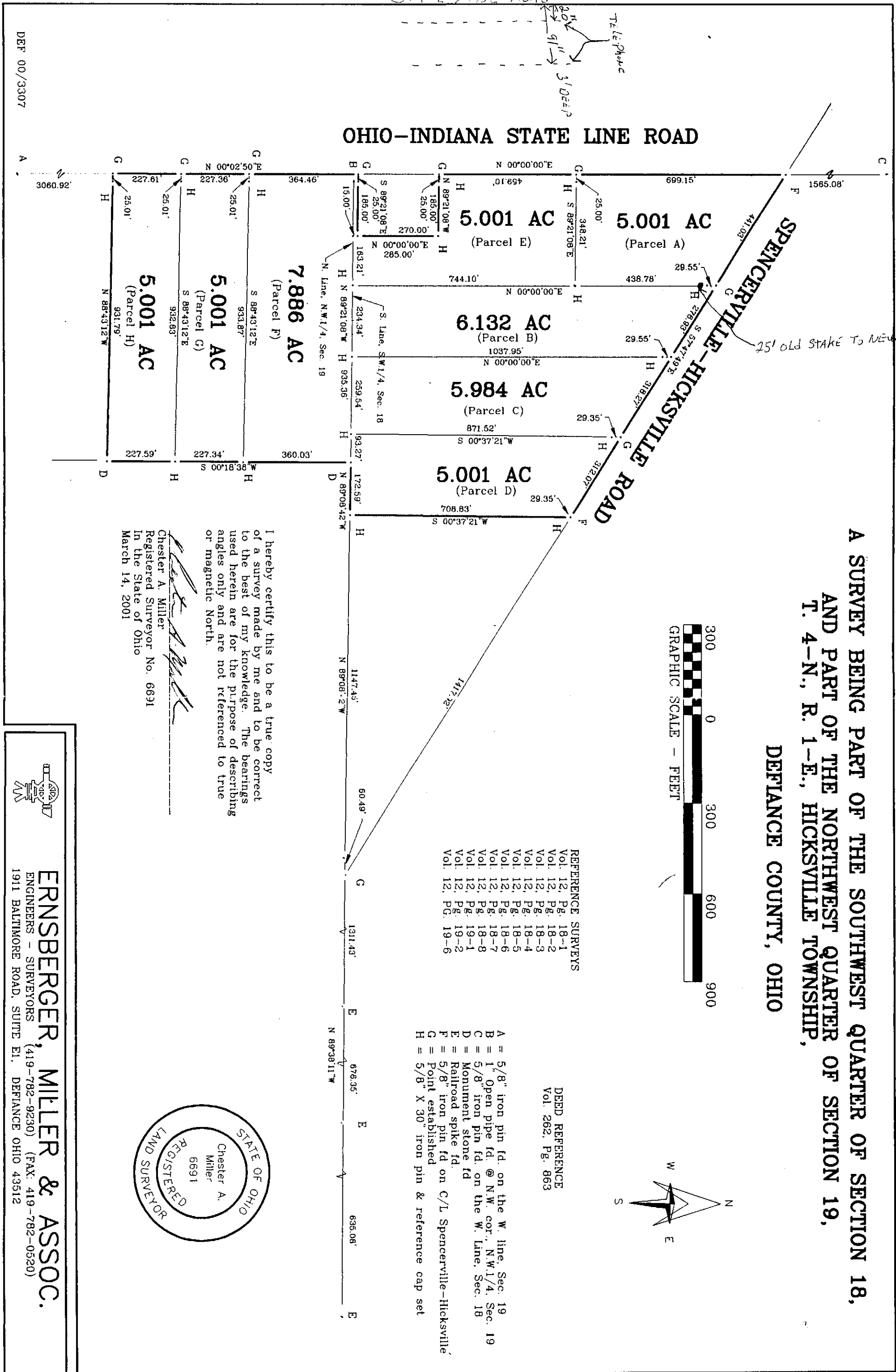

I hereby certify this to be a true copy of a survey made by me and to be correct to the best of my knowledge. The bearings used herein are for the purpose of describing angles only and are not referenced to true or magnetic North.

Chester A. Miller  
Registered Surveyor No. 6691  
In the State of Ohio  
March 14, 2001

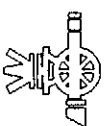
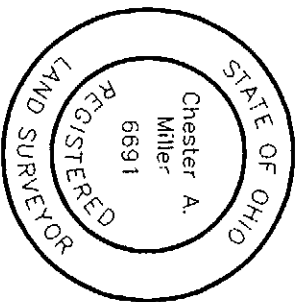

**ERNSBERGER, MILLER & ASSOC.**  
ENGINEERS - SURVEYORS (419-782-9230) (FAX: 419-782-0520)  
1911 BALTIMORE ROAD, SUITE E1, DEFIANCE OHIO 43512