

PROPERTY DESCRIPTION

0.383 Acres

Known as Part of Lot 11 of Edgerton's Outlots and part of Lot 12 of Edgerton's Outlots, Village of Hicksville, Defiance County, Ohio, being more specifically described as follows:

Commencing at the Original Northwest corner of Lot 12 of Edgerton's Outlots, said point being a point established this survey;

Thence, South 49 degrees 57 minutes 46 seconds East (assumed bearings) along the South right-of-way line of Spencerville Street a distance of 315.00 feet to a point established this survey and the TRUE POINT OF BEGINNING of the parcel herein described;

Thence, continuing South 49 degrees 57 minutes 46 seconds East along the South right-of-way line of Spencerville Street a distance of 12.31 feet to an iron pin placed this survey;

Thence, continuing South 49 degrees 57 minutes 46 seconds East along the South right-of-way line of Spencerville Street a distance of 93.00 feet to an iron pin placed this survey;

Thence, South 40 degrees 53 minutes 22 seconds West a distance of 178.35 feet to an iron pin placed this survey;

Thence, North 85 degrees 40 minutes 46 seconds West a distance of 35.00 feet to an iron pin found this survey;

Thence, North 4 degrees 19 minutes 14 seconds East a distance of 28.18 feet to an iron pin found this survey;

Thence, continuing North 4 degrees 19 minutes 14 seconds East a distance of 76.18 feet to an iron pin found this survey;

Thence, North 85 degrees 40 minutes 46 seconds West a distance of 16.40 feet to a point established this survey;

Thence, North 40 degrees 02 minutes 14 seconds East a measured distance of 123.60 feet to the TRUE POINT OF BEGINNING of the parcel herein described, containing 0.383 acres of land, more or less, and subject to highways rights-of-way and easements of record as surveyed by Brian M. Wieland, Registered Surveyor Number 8286 on October 6th, 2012 and recorded in the Defiance County Survey Records.

Monuments described above as "Iron Pins Set" are 5/8-inch diameter by 30-inch rebar with yellow plastic cap stamped "Wieland-8286."



Brian M. Wieland
Registered Surveyor No. 8286

PROPERTY DESCRIPTION

0.420 Acres

Known as Part of Lot 11 of Edgerton's Outlots and part of Lot 12 of Edgerton's Outlots, Village of Hicksville, Defiance County, Ohio, being more specifically described as follows:

Commencing at the Original Northwest corner of Lot 12 of Edgerton's Outlots, said point being a point established this survey;

Thence, South 49 degrees 57 minutes 46 seconds East (assumed bearings) along the South right-of-way line of Spencerville Street a distance of 420.31 feet to an iron pin placed this survey and the TRUE POINT OF BEGINNING of the parcel herein described;

Thence, continuing South 49 degrees 57 minutes 46 seconds East along the South right-of-way line of Spencerville Street a distance of 122.50 feet to an iron pin placed this survey;

Thence, South 4 degrees 12 minutes 22 seconds West a distance of 71.73 feet to a surveyors stake found this survey;

Thence, North 85 degrees 40 minutes 46 seconds West a measured distance of 205.86 feet to an iron pin placed this survey;

Thence, North 40 degrees 53 minutes 22 seconds East a distance of 178.35 feet to the TRUE POINT OF BEGINNING of the parcel herein described, containing 0.420 acres of land, more or less, and subject to highways rights-of-way and easements of record as surveyed by Brian M. Wieland, Registered Surveyor Number 8286 on October 6th, 2012 and recorded in the Defiance County Survey Records.

Monuments described above as "Iron Pins Set" are 5/8-inch diameter by 30-inch rebar with yellow plastic cap stamped "Wieland-8286."



Brian M. Wieland
Registered Surveyor No. 8286

PROPERTY DESCRIPTION
0.037 Acres
Transferred FROM Morrow TO Slattery

Known as Part of Lot 12 of Edgerton's Outlots, Village of Hicksville, Defiance County, Ohio, being more specifically described as follows:

Commencing at the Original Northwest corner of Lot 12 of Edgerton's Outlots, said point being a point established this survey;

Thence, South 49 degrees 57 minutes 46 seconds East (assumed bearings) along the South right-of-way line of Spencerville Street a distance of 420.31 feet to an iron pin placed this survey and the TRUE POINT OF BEGINNING of the parcel herein described;

Thence, continuing South 49 degrees 57 minutes 46 seconds East along the South right-of-way line of Spencerville Street a measured distance of 66.00 feet to a point established this survey;

Thence, North 85 degrees 40 minutes 46 seconds West a distance of 82.91 feet to a point established this survey;

Thence, North 40 degrees 53 minutes 22 seconds East a distance of 48.41 feet to the TRUE POINT OF BEGINNING of the parcel herein described, containing 0.037 acres of land, more or less, and subject to highways rights-of-way and easements of record as surveyed by Brian M. Wieland, Registered Surveyor Number 8286 on October 6th, 2012 and recorded in the Defiance County Survey Records.

Monuments described above as "Iron Pins Set" are 5/8-inch diameter by 30-inch rebar with yellow plastic cap stamped "Wieland-8286."

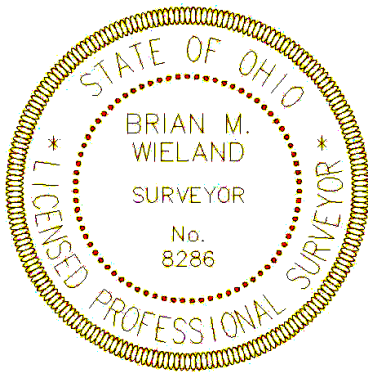

Brian M. Wieland

Brian M. Wieland
Registered Surveyor No. 8286

PROPERTY DESCRIPTION
0.176 Acres
Transferred FROM Slattery TO Morrow

Known as Part of Lot 11 of Edgerton's Outlots and part of Lot 12 of Edgerton's Outlots, Village of Hicksville, Defiance County, Ohio, being more specifically described as follows:

Commencing at the Original Northwest corner of Lot 12 of Edgerton's Outlots, said point being a point established this survey;

Thence, South 49 degrees 57 minutes 46 seconds East (assumed bearings) along the South right-of-way line of Spencerville Street a distance of 420.31 feet to a point established this survey;

Thence South 40 degrees 53 minutes 22 seconds West a distance of 48.41 feet to a point established this survey and the TRUE POINT OF BEGINNING of the parcel herein described;

Thence continuing South 40 degrees 53 minutes 22 seconds West a distance of 129.94 feet to an iron pin placed this survey;

Thence, North 85 degrees 40 minutes 46 seconds West a distance of 35.00 feet to an iron pin found this survey;

Thence, North 4 degrees 19 minutes 14 seconds East a distance of 28.18 feet to an iron pin found this survey;

Thence, continuing North 4 degrees 19 minutes 14 seconds East a distance of 76.18 feet to an iron pin found this survey;

Thence, South 85 degrees 40 minutes 46 seconds East a distance of 112.42 feet to the TRUE POINT OF BEGINNING of the parcel herein described, containing 0.176 acres of land, more or less, and subject to highways rights-of-way and easements of record as surveyed by Brian M. Wieland, Registered Surveyor Number 8286 on October 6th, 2012 and recorded in the Defiance County Survey Records.

Monuments described above as "Iron Pins Set" are 5/8-inch diameter by 30-inch rebar with yellow plastic cap stamped "Wieland-8286."

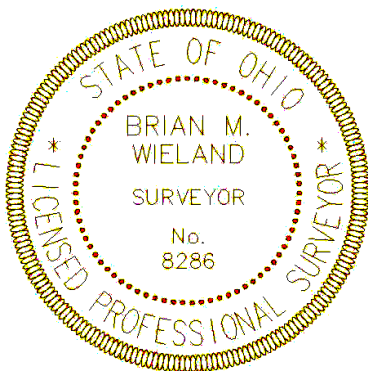

Brian M. Wieland
Registered Surveyor No. 8286