

**PLAT OF SURVEY
FOR
M. FROELICH**

SITUATED IN:
THE NE. 1/4, SECTION 28
TOWN 3 N. RANGE 5 E.,
HIGHLAND TOWNSHIP,
DEFIANCE COUNTY, OHIO

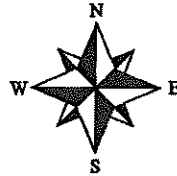

NORTH AND BEARING
SYSTEM BASED ON OHIO
NORTH STATE PLANE GRID,
NAD 83 ADJ. 2011.

HOFFMAN ROAD

NORTHEAST CORNER
NORTHEAST QUARTER
SECTION 28

W.D. AND R.C. RILEY
V. 269, PG. 151
1.500 AC.

S89°46'29"E 300.00'

S01°28'42"W 926.71'

S01°28'42"W 20.00'

S88°30'59"E
450.70'

N89°46'29"W 360.07'

L.C. WISEMAN
V. 402, PG. 2252
22.113 AC.

4.791 ACRES

C.C. BROWN
V. 190, PG. 777
3.513 AC.

LESTER G. KING
V. 244, PG. 917
V. 259, PG. 282
5.00 AC. DEED
0.29 AC. DEED

NOTES:

FOUND MONUMENTATION IN GOOD CONDITION
UNLESS OTHERWISE NOTED.
DATA SOURCES INCLUDE DOCUMENTS CITED.
A TITLE SEARCH IS RECOMMENDED TO DETERMINE
EASEMENTS, RESTRICTIONS, AND/OR OTHER
ENCUMBRANCES AFFECTING THE PROPERTY
SHOWN HEREON.

THIS PLAT IS BASED ON AN ACTUAL FIELD SURVEY.

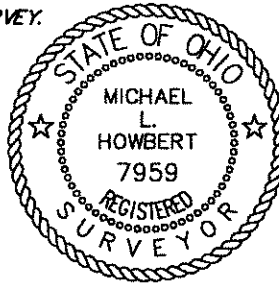

MICHAEL L. HOWBERT
REGISTERED PROFESSIONAL
SURVEYOR NO. 7959 IN OHIO
OCT 14, 2019

LEGEND:

- △ SPIKE FOUND
- 5/8" IRON PIN FOUND
- T STEEL T POST FOUND
- ⊙ 3/4" IRON PIPE FOUND
- 5/8" IRON PIN W/ CAP SET

HIGHLAND CENTER ROAD

N01°28'42"E 1702.49'

430.19'

N88°31'18"W

W.D. AND R.C. RILEY
V. 269, PG. 151
1.500 AC.

J. & A. MENERINK
V. 272, PG. 67
2.102 AC.

SOUTHEAST CORNER
NORTHEAST QUARTER
SECTION 28

**HOWBERT
SURVEYING
LLC**
8477 MERICLE ROAD
FORT JENNINGS, OHIO 45844
419-863-0289

DATE: 10/14/19	REV:
CLIENT: M. FROELICH	SCALE: 1" = 100'
JOB #: 385-10-19	CHK:



SCALE 1"=100'

04-28-24



8477 MERCILE ROAD
FORT JENNINGS, OHIO 45844
419-863-0289

Description 4.791 Acres

Situated in the Northeast Quarter of Section 28, Town 3 North, Range 5 East, Highland Township, Defiance County, Ohio, being all of a 5 acre tract as described in Volume 244, Page 917 and all of a 0.29 acre tract as described in Volume 259, Page 282, being more particularly described as follows;

Commencing at the northeast corner of the northeast quarter of said Section 28, being a spike found;

Thence along the east line of said northeast quarter, S01°28'42"W, a distance of 926.71 feet to the **Principal Point of Beginning**;

Thence continuing on said east line of said northeast quarter, S01°28'42"W, a distance of 20.00 feet to the northeast corner of a 3.513 acre tract as described in Volume 190, Page 777;

Thence along said tract on the following two (2) courses and distances:

1. N89°46'29"W., a distance of 360.07 feet to a 5/8" iron pin found, passing a 5/8" iron pin found at 20.00 feet;
2. S01°32'29"W., a distance of 447.61 feet to a 5/8" iron pin found;

Thence along the north line of a 5 acre tract as described in Volume 269, Page 151, N88°31'18"W, a distance of 430.19 feet to the southeast corner of a 22.113 acre tract as described in Volume 402, Page 2252, witness a 5/8" iron pin found 20.31 feet west;

Thence along said tract on the following three (3) courses and distances:

1. N01°28'42"E., a distance of 468.09 feet to a 5/8" iron pin found;
2. S88°30'59"E., a distance of 450.70 feet to a 5/8" iron pin found;
3. S89°46'29"E., a distance of 40.04 feet to the southwest corner of an 1.500 acre tract as described in Volume 269, Page 151, being a iron t post found;

Thence on the north line of a 0.29 acre tract as described in Volume 259, Page 282, S89°46'29"E., a distance of 300.00 feet to the **Principal Point of Beginning**, passing a 5/8" iron pin found at 280.00 feet;

Containing 4.791 acre, more or less, and being subject to all legal highways, rights-of-way, easements, restrictions, covenants, and/or conditions of record.

The above description and bearing system is based on a survey prepared by Michael L. Howbert, Registered Professional Surveyor, No. 7959, in October of 2019.

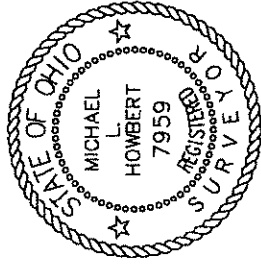

Michael L. Howbert, P.S.