

LEGEND

- 5/8 INCH REBAR WITH ID CAP SET
- 5/8 INCH REBAR WITH ID CAP FOUND
- MAG MAG NAIL SET
- D-FD DEFIANCE CO. ENGINEER DISK FOUND
- POB POINT OF BEGINNING

NOTE: SURVEY BEARINGS BASED ON OHIO NORTH ZONE STATE PLANE COORDINATES OBTAINED FROM THE OHIO DOT VRS NETWORK

I HEREBY CERTIFY THIS TO BE A SURVEY MADE UNDER MY SUPERVISION AND THAT THE MONUMENTS ARE FOUND AND/OR SET AS INDICATED.

12-6-16
Date

Gregory A. Bockrath
Gregory A. Bockrath, P.S.
Registered Surveyor No. 8306.
115 S. Fair Avenue, Suite A
Ottawa, Ohio 45875
419-523-5789

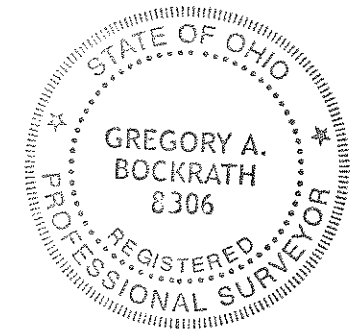

FRANCIS E. & DOROTHY J. PESSEFALL, CO-TRUSTEES
OR VOL 304 - PG 1247
58.84 ACRES (RECORDED)
55.34 AC. (PER TAX RECORD)
PARCEL NO. G19-0011-0-008-00

THIS SURVEY WAS PERFORMED WITHOUT THE BENEFIT OF A TITLE EXAMINATION. BEYOND THE DEED DOCUMENTS CITED ON THE SURVEY DRAWING THERE MAY BE RECORDED OR UN-RECORDED EASEMENTS AND/OR ENCUMBRANCES BENEFITING OR ENCUMBERING THE SURVEYED PROPERTY WHICH ARE NOT SHOWN ON THIS DRAWING.

SURVEY PLAT FOR: RYAN PESSEFALL	
PART OF THE E 1/2 OF THE NE 1/4 OF SECTION 11, T4N - R2E, MARK TOWNSHIP, DEFIANCE COUNTY, OHIO	
BOCKRATH & ASSOCIATES ENGINEERING and SURVEYING, LLC 115 S. FAIR AVENUE SUITE A - OTTAWA, OH 45875 PHONE: 419-523-5789 - FAX: 419-523-5799	1 1