

Chester A. Miller, P.S.
2134 Royal Palm Ave.
Defiance, Ohio 43512
(419)-782-4927

D830011

August 12, 1983

A parcel of land situated in the West Half of the Northwest Quarter of Section 22, T-4-N, R-4-E, Noble Township, Defiance County, Ohio, and being more particularly described as follows:

Commencing for reference at the northwest corner of section 22: thence with the north line of section 22 and the centerline of Roehrig Road North 90-00'-00" East a distance of 1055.12' feet to an iron pin (set) and being the TRUE POINT OF BEGINNING for the parcel herein described:

thence with the north line of said section 22 and centerline of said road North 90-00'-00" East a distance of 621.65' feet an iron pin (found) at the centerline intersection of Roehrig Road and Switzer Road;

thence with the centerline of Switzer Road South 37-22'-29" West a distance of 347.50' feet to an iron pin (set);

thence South 85-08'-01" West a distance of 30.39' feet to an iron pin (set); thence containing South 85-08'-01" West a distance of 379.27' feet to an iron pin (set);

thence North 0-27'-51" West a distance of 290.92' feet to an iron pin (set); thence containing North 0-27'-51" West a distance 20.00' feet to iron pin (set) and the TRUE POINT OF BEGINNING for the parcel herein described containing 3.428 acres of land more or less and being subject to all legal highways and easements of record.

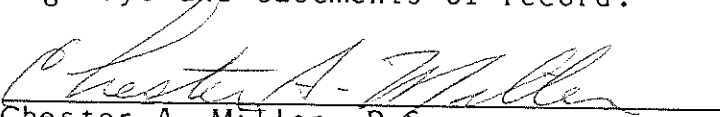
Chester A. Miller, P.S.
Reg. Surveyor #6691

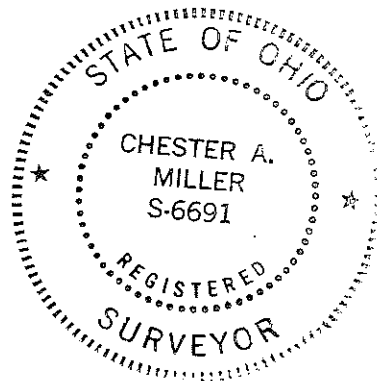

Chester A. Miller, P.S.
2134 Royal Palm Ave.
Defiance, Ohio 43512
(419)-782-4927

D830011

August 12, 1983

A parcel of land situated in the West Half of the Northwest Quarter of Section 22, T-4-N, R-4-E, Noble Township, Defiance County, Ohio, and being more particularly described as follows:

Commencing for reference at the northwest corner of section 22; thence with the north line of section 22 and the centerline of Roehrig Road North 90-00'-00" East a distance of 601.84' feet to iron pin (set) and being the TRUE POINT OF BEGINNING for the parcel herein described:

thence with the north line of said section and the centerline of said road North 90-00'-00" East a distance of 453.28' feet to an iron pin (set);

thence South 0-27'-51" East a distance of 20.00' feet to an iron pin (set); thence containing South 0-27'-51" East a distance of 290.92' feet to an iron pin (set);

thence South 85-08'-01" West a distance of 454.61' feet to a wood fence post;

thence North 0-27'-51" West a distance of 329.48' feet to an iron pin (set); thence containing North 0-27'-51" West a distance of 20.00 feet to an iron pin (set) and the TRUE POINT OF BEGINNING for the parcel herein described containing 3.436 acres of land more or less and being subject to all legal highways and easements of record.

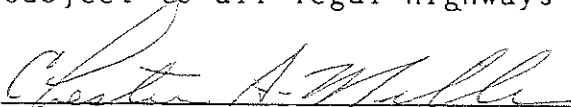

Chester A. Miller, P.S.
Reg. Surveyor #6691

