

PROPERTY DESCRIPTION
0.098 Acres

Being a parcel of land known as part of a Vacated Alley and the North Half of Lot 41 in Miller and Others Addition to the Village of Sherwood situated in the Southeast Quarter of Section 19, Town 4 North, Range 3 East, Delaware Township, Sherwood Village, Defiance County, Ohio. Located within the North and East of the First Principal Meridian of the Original Land Subdivisions of Ohio, being more specifically described as follows:

Commencing at the Northeast Corner of Lot 41 of Miller and Others Addition, said point being a PK Nail found this survey and the TRUE POINT OF BEGINNING of the parcel herein described;

Thence, South 1 degree 20 minutes 28 seconds West along the West right of way line of Harrison Street a measured distance of 31.00 feet to a point established this survey;

Thence, North 87 degrees 43 minutes 32 seconds West a distance of 138.00 feet to a point established this survey;

Thence, North 1 degree 20 minutes 28 seconds East along the East right of way line of an alley a measured distance of 31.00 feet to an iron pin placed this survey;

Thence, South 87 degrees 43 minutes 32 seconds East along the South right of way line of Pearl Street a distance of 138.00 feet to the TRUE POINT OF BEGINNING of the parcel herein described, containing 0.098 acres of land, more or less, and subject to highways rights-of-way and easements of record as surveyed by Brian M. Wieland, Registered Surveyor Number 8286 on July 11th, 2018 and recorded in the Defiance County Survey Records.

Bearings and distances are based on State Plane Coordinates, SPC83, Zone-Ohio North. Monuments described above as "Iron Pins Set" are 5/8-inch diameter by 30-inch rebar with yellow plastic cap stamped "Wieland-8286."



A handwritten signature in black ink that reads "Brian M. Wieland".

Brian M. Wieland
Registered Surveyor No. 8286

PROPERTY DESCRIPTION
0.111 Acres

Being a parcel of land known as a part of a Vacated Alley and the South part of Lot 41 in Miller and Others Addition to the Village of Sherwood situated in the Southeast Quarter of Section 19, Town 4 North, Range 3 East, Delaware Township, Sherwood Village, Defiance County, Ohio. Located within the North and East of the First Principal Meridian of the Original Land Subdivisions of Ohio, being more specifically described as follows:

Commencing at the Northeast Corner of Lot 41 of Miller and Others Addition, said point being a PK Nail found this survey;

Thence, South 1 degree 20 minutes 28 seconds West along the West right of way line of Harrison Street a measured distance of 31.00 feet to a point established this survey and the TRUE POINT OF BEGINNING of the parcel herein described;

Thence, continuing South 1 degree 20 minutes 28 seconds West along the West right of way line of Harrison Street a deed distance of 35.00 feet to an iron pin placed this survey;

Thence, North 87 degrees 43 minutes 32 seconds West a distance of 138.00 feet to an iron pin placed this survey;

Thence, North 1 degree 20 minutes 28 seconds East along the East right of way line of an alley a deed distance of 35.00 feet to a point established this survey;

Thence, South 87 degrees 43 minutes 32 seconds East a distance of 138.00 feet to the TRUE POINT OF BEGINNING of the parcel herein described, containing 0.111 acres of land, more or less, and subject to highways rights-of-way and easements of record as surveyed by Brian M. Wieland, Registered Surveyor Number 8286 on July 11th, 2018 and recorded in the Defiance County Survey Records.

Bearings and distances are based on State Plane Coordinates, SPC83, Zone-Ohio North. Monuments described above as "Iron Pins Set" are 5/8-inch diameter by 30-inch rebar with yellow plastic cap stamped "Wieland-8286."

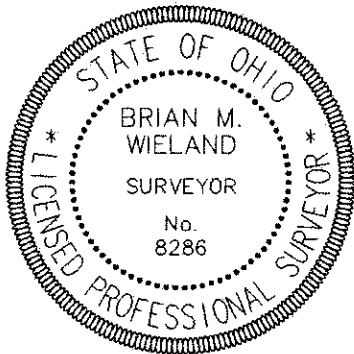

Brian M. Wieland
Registered Surveyor No. 8286