

S 89°41' 19" E 2654.28' M 2656.17' R

~BOSTATER ROAD~

POC

S 89°41' 19" E 1173.14'
NW COR.,
NW 1/4,
SEC. 23

POB

NORTH LINE, NW 1/4, SEC. 23

S 89°41'19" E 1481.14'
(ASSUMED BEARING)

NE COR.,
NW 1/4,
SEC. 23

14.888 ACRES

PART PN. L15-0023-0-004-00

JOSHAWA & NATALIE J. ZACHRICH

OR VOL 430 - PG 2795

160 AC. (RECORDED)

PN. L15-0023-0-003-00

~MULLIGANS BLUFF ROAD~

W. LINE, NW 1/4 N 00°52' 43" E 2652.83' M

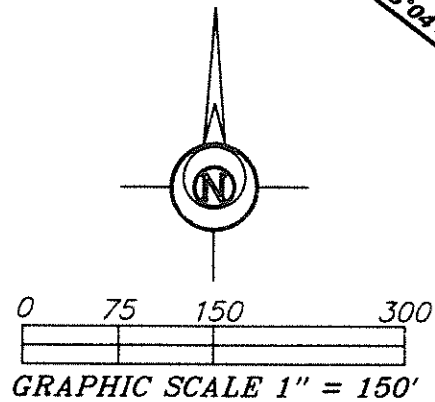

LEGEND

- 5/8 INCH REBAR W/ID CAP SET
- 5/8 INCH REBAR W/ID CAP FOUND
- 1/2 INCH REBAR FOUND
- POB POINT OF BEGINNING
- POC POINT OF COMMENCEMENT
- R RECORDED
- M MEASURED

DAVID J. KARLSTADT, TRUSTEE

OR VOL 392 - PG 182

147.835 AC. (RECORDED)

PN. L15-0023-0-004-00

SURVEY REFERENCES:
08-23-04, MILLER, 9/21/1987
WOOD CO. ENG. SEC. CORNER REFERENCES

SW COR.,
NW 1/4,
SEC. 23

N 89°38' 22" W 2666.51'

S. LINE, NW 1/4

INT. OF CLs
SE COR.,
NW 1/4,
SEC. 23

N 89°38' 22" W 2666.86'

SE COR.,
NE 1/4,
SEC. 23

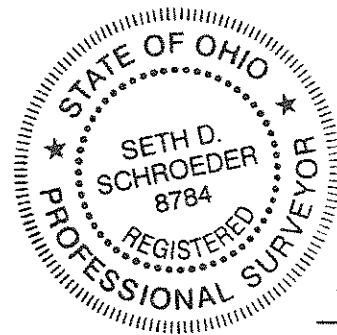

I HEREBY CERTIFY THIS TO BE A SURVEY MADE UNDER MY SUPERVISION AND THAT THE MONUMENTS ARE FOUND AND/OR SET AS INDICATED.

4-3-23
Date

Seth D. Schroeder, P.S.
Registered Surveyor No. 8784
115 S. Fair Avenue, Suite A
Ottawa, Ohio 45875

NOTE: SURVEY BEARINGS BASED ON OHIO NORTH ZONE STATE PLANE COORDINATES OBTAINED FROM THE OHIO DOT VRS NETWORK

THIS SURVEY WAS PERFORMED WITHOUT THE BENEFIT OF A TITLE EXAMINATION. BEYOND THE DEED DOCUMENTS CITED ON THE SURVEY DRAWING THERE MAY BE RECORDED OR UN-RECORDED EASEMENTS AND/OR ENCUMBRANCES BENEFITING OR ENCUMBERING THE SURVEYED PROPERTY WHICH ARE NOT SHOWN ON THIS DRAWING.

SURVEY PLAT FOR: DAVE KARLSTADT

PART OF THE NW 1/4
OF SECTION 23,
T5N - R3E,
WASHINGTON TOWNSHIP,
DEFIANCE COUNTY, OHIO

Bockrath & Associates
Engineering and Surveying, LLC
115 S. Fair Avenue, Suite A - Ottawa - Ohio
Phone: 419.523.5789

1/1